

XJTU



MINI GUIDE TO UNDERGRADUATE AND **MASTERS** IN 2020



Xi'an Jiaotong-Liverpool University
西交利物浦大學

CONTENTS

05 WHY XJTLU?	17 BUDGET & LIVING AT XJTLU
06 ACADEMIC QUALITY	19 CAREERS & FURTHER STUDY
07 DISTINGUISHED FACULTY	21 GLOBAL OPPORTUNITIES
09 EXPERIENCE CHINA	23 STUDENT SUPPORT
11 AWARD-WINNING CAMPUS	27 SCHOLARSHIPS
13 STUDENT LIFE	29 UNDERGRADUATE PROGRAMMES
15 ACCOMMODATION	35 MASTER'S PROGRAMMES

FIND YOURSELF... WITH A UK DEGREE IN CHINA



You are the future entrepreneur, scientist, architect, engineer, diplomat, researcher, educator or executive in our increasingly global environment.

You have a passion to understand other cultures and become a citizen of the world.

We want you.

At Xi'an Jiaotong-Liverpool University you will find an international community of learners in the heart of China's economic miracle – and opportunities found nowhere else on Earth.

XJTLU will help you develop into a global citizen with the skills, knowledge, abilities, temperament and tenacity to succeed in today's highly competitive and fast-changing world.

We look forward to welcoming you to XJTLU.



XJTLU AT A GLANCE



UK DEGREE FROM THE UNIVERSITY OF LIVERPOOL

Earn a globally recognised degree from the University of Liverpool; Undergraduates also gain the XJTLU degree from the Chinese Ministry of Education.



AN EXCITING RANGE OF PROGRAMMES

Study sciences, technology, engineering, mathematics, architecture, design and planning, language and culture, media and communications, business, finance or economics.



ENGLISH-TAUGHT

All programmes are taught 100 percent in English.



WORLD-CLASS CAMPUS

State-of-the-art facilities located on a beautifully landscaped campus.



GROWING GLOBAL COMMUNITY

Almost 15,000 students and 650 academic staff from 50 countries...and counting!



LEARN CHINESE FOR TOP CAREER PROSPECTS

The opportunity to study Chinese language at all levels. Bilingual China experts are highly sought-after in the global job market.



SINO-BRITISH EXCELLENCE

Founded in 2006, XJTLU is the largest international collaborative university in China, combining the best of east and west.



LOCATED IN SUZHOU, CHINA

China's equivalent of Silicon Valley, a hub of global business and innovation just 25 minutes from Shanghai, sits alongside stunning 2,500 year-old UNESCO World Heritage gardens.

WHY XJTLU?

Xi'an Jiaotong-Liverpool University is a pioneering, international joint venture university. We are proud of our focus on research-led learning inherited from our two co-founding institutions: the University of Liverpool and Xi'an Jiaotong University.

ENGLISH LANGUAGE ENVIRONMENT ON CAMPUS

All degree programmes are taught 100 percent in English, making it easy to access your China experience while continuing your course of study.

MIX OF SUBJECTS ACROSS STEM, HUMANITIES AND SOCIAL SCIENCES

Study sciences, technology, engineering, mathematics, design and planning, architecture, public health, language and culture, China studies, business, finance, media and communications.

WORLD-CLASS CAMPUS

State-of-the-art facilities are located on a beautifully landscaped campus.

UK QUALITY ASSURANCE

XJTLU programmes are accredited and moderated by the University of Liverpool. With degree programmes across many subject areas, plus the China context, you're able to make the most of your academic experience abroad.

LEARN A NEW LANGUAGE

Alongside your degree, all international students can study Mandarin Chinese and are encouraged to pass HSK tests at the Suzhou testing center. If you already know Chinese, you can take top-up classes, or study Spanish or Japanese.



"I was so surprised to find how convenient it is to live in China! The people are kind, and the food is delicious. I was really impressed to see modern downtown areas even though Suzhou is also an ancient, historical city."

PARK JAEHYUN, KOREA
SUMMER SCHOOL

ACADEMIC QUALITY AND PROFESSIONAL RECOGNITION

Many of our programmes have also been recognised by prestigious academic and professional accrediting bodies such as AACSB International, EQUIS, the Royal Institute of British Architects (RIBA), Joint Board of Moderators, Royal Society of Biology and the Institution of Engineering and Technology (IET), for example.

We are one of the youngest universities in the world to have earned these accreditations.

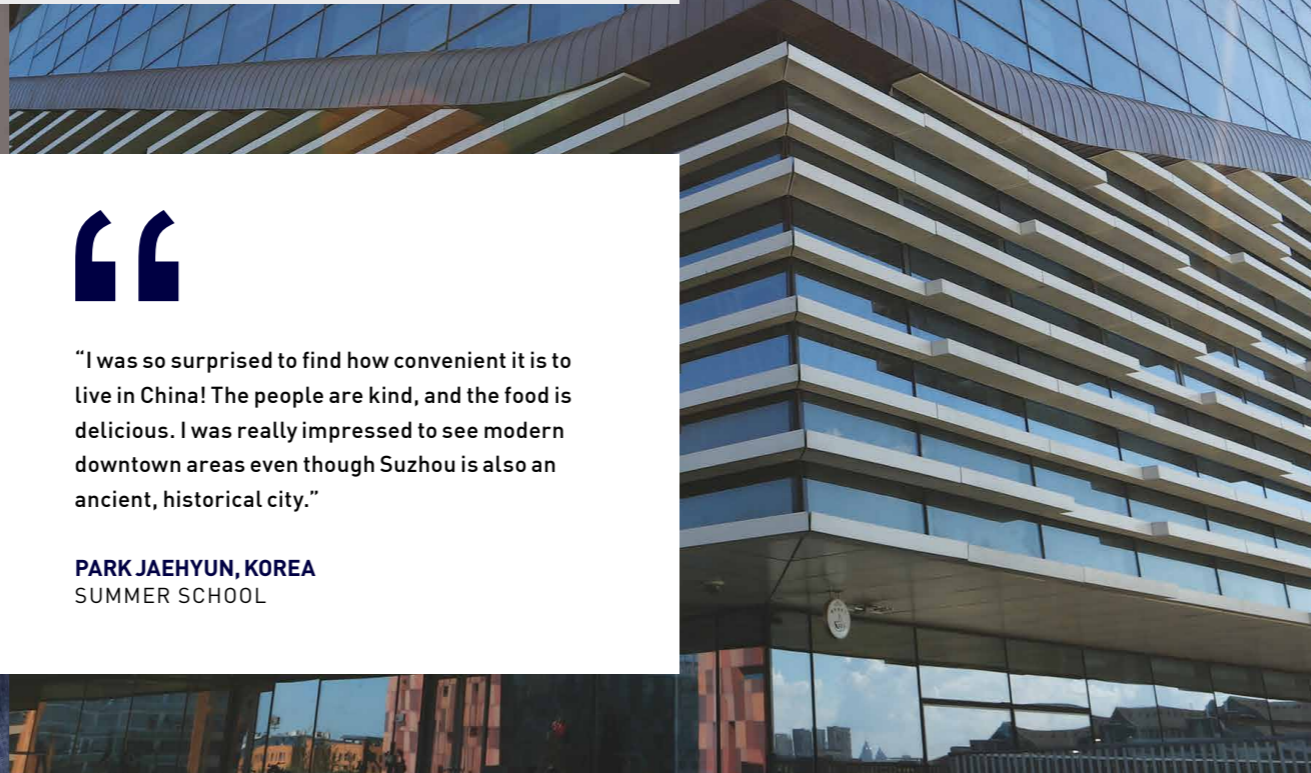

DISTINGUISHED INTERNATIONAL FACULTY AND RESEARCHERS

XJTLU has almost 650 academic staff from more than 50 countries and regions, who have extensive international experience in industry and academia. They deliver cutting-edge research and teach current theories to prepare you for an excellent career.



PROFESSOR ENG GEE LIM
ARTIFICIAL INTELLIGENCE
UNIVERSITY RESEARCH CENTRE



DR GRAHAM DAWSON
CHEMISTRY



PROFESSOR JOHANNES KNOPS
HEALTH AND ENVIRONMENTAL SCIENCES



DR KONSTANTINOS PAPDIKIS
CIVIL ENGINEERING

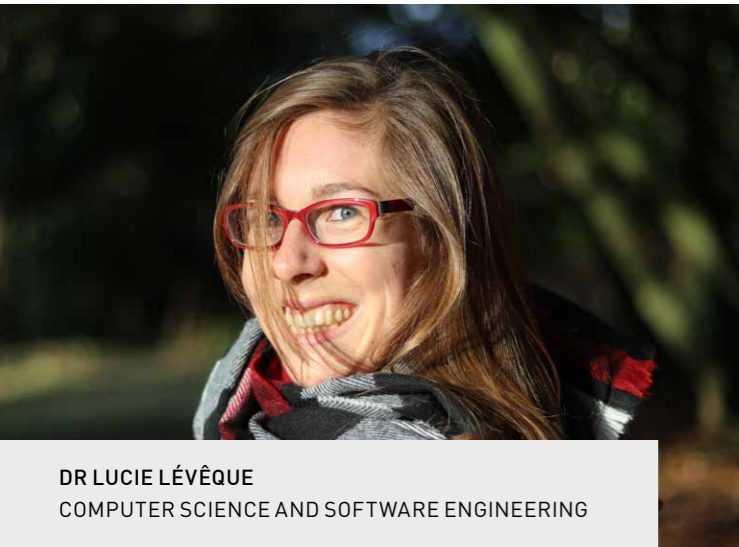

DR LUCIE LÉVÉQUE
COMPUTER SCIENCE AND SOFTWARE ENGINEERING



PROFESSOR KAIZHU HUANG
ELECTRICAL AND ELECTRONICAL ENGINEERING



DR ALESSANDRA CAPPELLETTI
INTERNATIONAL RELATIONS



DR KEPING WU
CHINA STUDIES



DR JUANN HUNG
INTERNATIONAL BUSINESS SCHOOL, SUZHOU



PROFESSOR GISELA LÖHLEIN
ARCHITECTURE

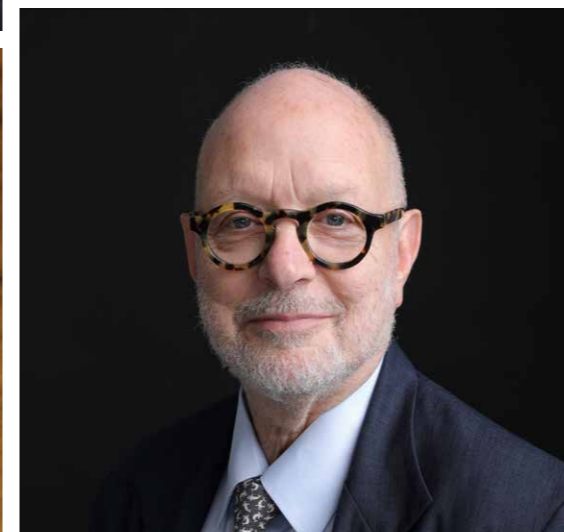

PROFESSOR DAVID GOODMAN
VICE PRESIDENT, ACADEMIC AFFAIRS



DR GARRABOST DONALD JAYALAKSHMI
SCHOOL OF FILM AND TV ARTS



EXPERIENCE CHINA

With the Chinese century upon us, no matter what career you pursue, China will play a role in your future in one way or another. How can first-hand experience of China make the difference for you?

CAREER PROSPECTS

Employers report that experience in China helps graduates stand out from the crowd. You'll develop an understanding of the world's second largest economy and inter-cultural skills that will give you a leg-up in your next job hunt.

FRIENDSHIPS AND NETWORKS

Studying abroad is fun! Not only will you experience new people, food, customs and travel, but you'll make new friends in China and from across the globe that will last a lifetime.

CULTURAL AWARENESS

China offers a continent full of diverse culture, food styles and dramatic scenery. Shanghai, Xi'an and Beijing are well within the range of a weekend trip. Spend more time and you can explore the Silk Road, traversing deserts, high plateau grasslands and glacial valleys. Or, visit giant pandas in Chengdu or Buddhist monks in Tibet. The possibilities are limitless!

LANGUAGE SKILLS

More than one billion people of the world's population speak Chinese, and it will become increasingly influential in the future. Learning Chinese language may be a part of your study path at XJTLU, but even scratching the surface will give you a greater insight into a fascinating and ancient society that will also contribute to your career prospects.

LIVE IN BEAUTIFUL SUZHOU

Suzhou is a fascinating mix of the ancient and the hypermodern; blending together a bustling old town with canals, elegant 2,500 year-old UNESCO World Heritage gardens, new lakeside areas with stunning malls, skyscrapers, shops and restaurants; and one of Asia's leading research and innovation hubs. Suzhou's weather is cold in winter and hot in summer.

XJTLU CAMPUS

XJTLU is located in the modern, clean and safe Suzhou Industrial Park area, China's equivalent of Silicon Valley and a hub of global education, business and innovation with more than 20 universities, 5,000 foreign owned enterprises and Fortune 500 companies to bring real-life opportunity into the classroom.

SHANGHAI

Located just 25 minutes by bullet train from Suzhou, Shanghai is one of Asia's most glamorous cities with over 25 million people and one of the most vibrant economic, cultural and nightlife scenes in the world. Be a part of the action in this global hub of finance, arts, fashion and food.

KEY FACTS

LOCATION	JIANGSU PROVINCE, EAST CHINA
POPULATION	11 MILLION
GDP	RMB 1.3 TRILLION (USD 190 BILLION)
TIME ZONE	GMT +8 HOURS
WEATHER	JANUARY (1-5 C) JULY (28-35 C)
AIRPORTS	SHANGHAI HONGQIAO (74KM) SHANGHAI PUDONG (123KM) WUXI SUNAN SHUOFANG (51KM)



"Suzhou is ideally located as a gateway for you to travel across China and Asia. The diversity of people at XJTLU gives you the opportunity to meet other like-minded students from around the world."

ANNA HALL, UK
CHINESE LANGUAGE
SUMMER SCHOOL



AWARD-WINNING CAMPUS

The XJTLU campus provides state-of-the-art teaching, laboratory, research and support facilities.

This includes the award-winning Central Building, which houses the fully-resourced XJTLU Library.

In addition to the world-class science and engineering laboratories, design and media studios, and communications laboratories, our campus also has conference facilities, tennis and basketball courts, multi-purpose sports centre, playing ground, running track, and a variety of catering facilities.



XJTLU NORTH CAMPUS



XJTLU SOUTH CAMPUS

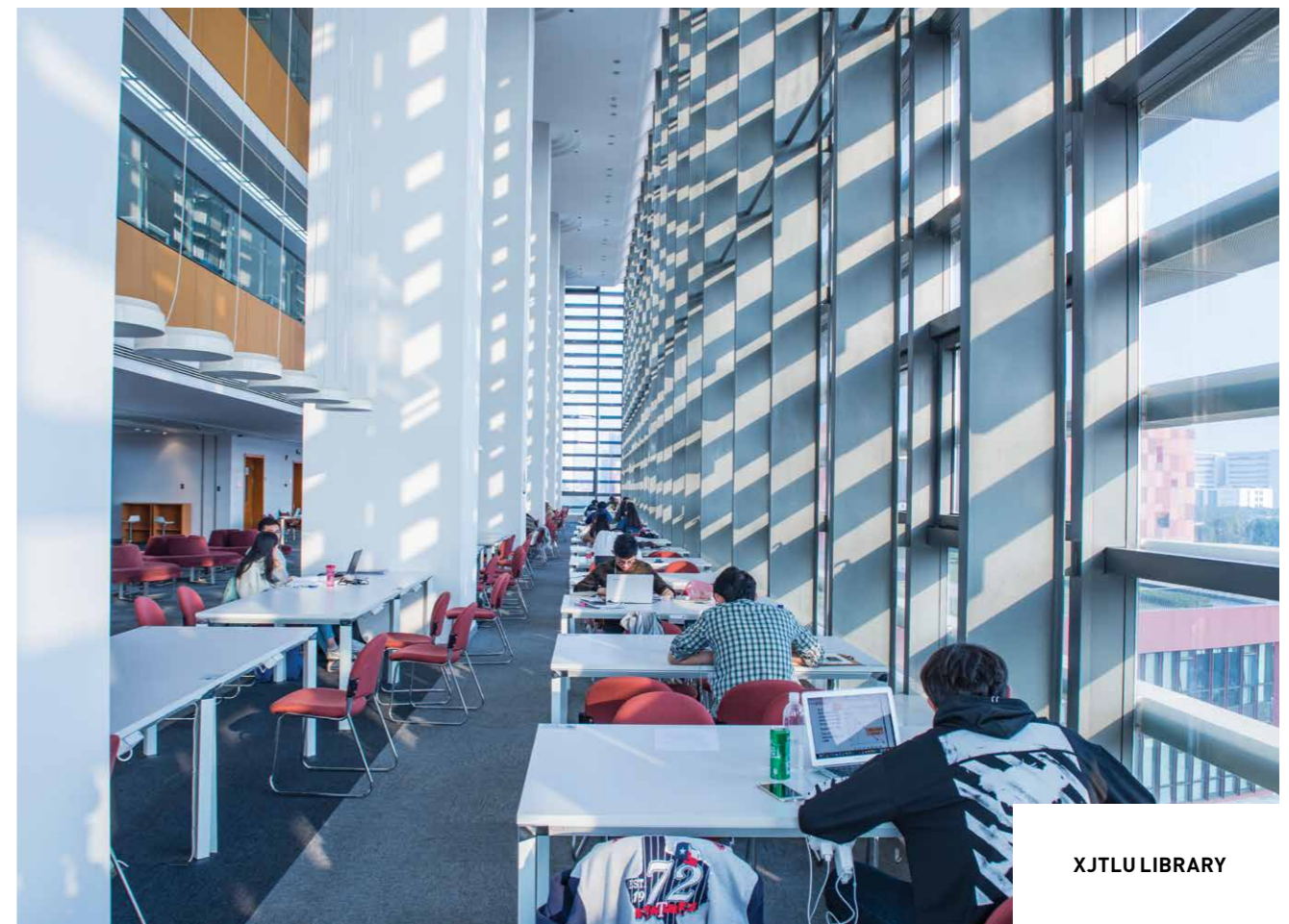

XJTLU LIBRARY

STUDENT LIFE

An education at XJTLU brings with it not only outstanding academic opportunities, but also the chance to expand one's horizons socially and culturally.

XJTLU students study hard, but they also lead full and ambitious lives between classes. Student clubs and societies play an important role at XJTLU with more than 120 organisations centred on art, sports, entrepreneurship, social service, academia and science to name but a few.

XJTLU hosts a model United Nations, and the Student Union plays an active role in shaping campus life and academic experiences. We also have an arts centre that gives students the opportunity to get involved in a range of creative activities. The campus has its own student enterprise park where students can try starting their own businesses or simply enjoy the shops and services.

You'll also have the chance to travel through China's vast and beautiful landscape and experience the depth of its ancient culture.



XJTLU SPORTS CENTRE

SELECTION OF STUDENT CLUBS AND ACTIVITIES

- ACTION! GREENER
- ART TRAINING CENTRE
- BILLIARDS CLUB
- BIOSCIENCE CLUB
- BUDDY PROGRAMME
- COMMUNICATION SOCIETY
- CRICKET CLUB
- DEBATING CLUB
- HISTORY CLUB
- KARATE CLUB
- LEMEI CHARITY
- LOX-TV
- MODEL UNITED NATIONS
- STUDENT UNION
- SCIENCE & INNOVATION ASSOCIATION
- STUDENT AMBASSADOR ASSOCIATION
- STUDENT ENGLISH ASSOCIATION
- STUDENT NEWS CENTRE
- VOLUNTEER ASSOCIATION
- ULTIMATE FRISBEE CLUB

SPORTS FACILITIES

- RUNNING TRACKS
- TENNIS COURTS
- BASKETBALL COURTS
- FOOTBALL FIELDS
- INDOOR GOLF PRACTICE
- SPORTS HALL
- FITNESS AND WEIGHTS
- ROCK CLIMBING WALL
- DANCE AND YOGA STUDIOS

FOOD AND SHOPPING

- CANTEENS AND COFFEE SHOPS
- BARS AND RESTAURANTS
- DOWNTOWN SUZHOU



ACCOMMODATION

The accommodation facilities are located between 5 to 20 minutes from campus and cater to different living styles from private hotel standard rooms to functional single en-suites with shared communal facilities.

After you receive your offer, you can book your accommodation using our booking system. Accommodation is guaranteed, however availability varies and choice is on a first come, first serve basis.

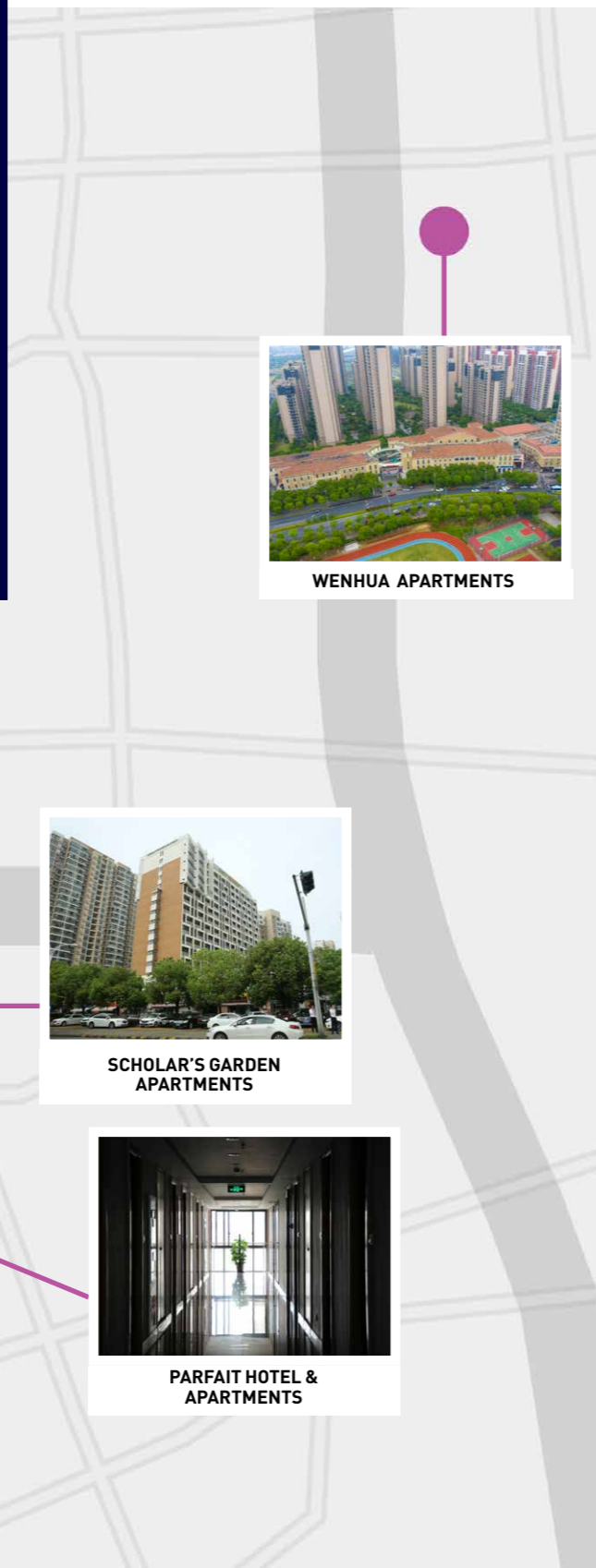

WENHUA APARTMENTS



MBA APARTMENTS



SCHOLAR'S GARDEN APARTMENTS



PARFAIT HOTEL & APARTMENTS



PARFAIT INTERNATIONAL APARTMENTS

	 Kitchen	 En-suite bathroom option	 Prices per month	 Distance to Campus
WENCUI: PARFAIT INTERNATIONAL APARTMENTS				
	Yes, shared	Private	1,488-2,170 RMB (\$USD 209-305)	1km
WENCUI: PARFAIT HOTEL & APARTMENTS				
	Only microwave and fridge	Private	2,046-3,100 RMB (\$USD 287-435)	1km
MBA APARTMENTS				
	No	Shared by 3 students	1,333-1,922 RMB (\$USD 187-270)	1km
SCHOLAR'S GARDEN APARTMENTS				
	Yes	Private	2,542-3,162 RMB (\$USD 356-443)	1km
WENHUA APARTMENTS				
	Yes, shared	Private	1,550-2,170 RMB (\$USD 218-304)	7km

BUDGET

Suzhou is a beautiful, safe, modern affordable city just 24 minutes from Shanghai, and was recently rated in the Economist magazine as the 'most liveable city in mainland China'. You get all the benefits of living a big city but without the high costs.

Compared to other modern cities around the world, living costs are much lower in Suzhou.

Below are three sample lifestyles which you can refer to when planning your budget.



CUP OF COFFEE
15 - 35 RMB
(US\$ 2 - 5)



CANTEEN LUNCH
20 RMB
(US\$ 3)



FAST FOOD
35 RMB
(US\$ 5)



CINEMA TICKET
50 - 80 RMB
(US\$ 7 - 11)



HAIRCUT
25 - 200 RMB
(US\$ 3.50 - 28)



SWIMMING ACCESS
15 - 35 RMB
(US\$ 1.50 - 2)



BUS TICKET
1 - 2 RMB
(US\$ 0.15 - 0.30)



SUBWAY TICKET
2 - 7 RMB
(US\$ 0.35 - 1)



TRAIN TO SHANGHAI
40 RMB
(US\$ 5.50)

LIVING AT XJTLU

Work hard and play hard at XJTLU. Your time outside the classroom is full of possibilities, adventure and new experiences.



Enjoy a cup of coffee with a serene view at the Jinji and Dushu lake area

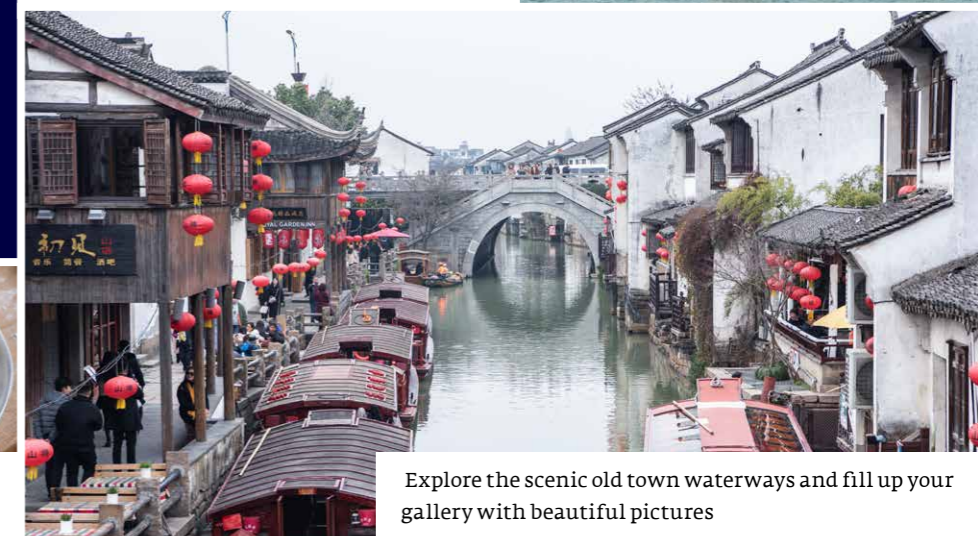

Explore the scenic old town waterways and fill up your gallery with beautiful pictures



Try delicious local Chinese dishes from small vendors and traditional restaurants

LIFESTYLE A

Lives in university dorms and lives cheaply. Only eats food from the university canteen, avoids nightlife, and occasionally takes the bus or metro around town.

LIFESTYLE B

Lives in university dorms and lives cheaply during the week, but occasionally treats themselves. Enjoys nightlife once a month. Normally takes the bus but will take a few taxis each month.

LIFESTYLE C

Lives in a private apartment and lives a full lifestyle. Eats in a variety of restaurants and enjoys nightlife each week. Owns an electric bike and often takes the taxi.

RENT	1,500	1,500	3,000
UTILITIES	300	300	500
FOOD	1,000	2,000	3,000
TRANSPORT	100	200	500
LUXURIES	200	500	1,000
TOTAL MONTHLY	3,100 RMB (around USD\$440)	4,500 RMB (around USD\$630)	8,000 RMB (around USD\$1,120)

In addition to your tuition fees, travel and monthly living costs, you should also allocate budget for:

- Service charges (textbooks, ID cards, printing etc.) : 1,000 RMB / semester
- Visa/residence permit costs (varies for each country) : 500-1,000 RMB
- Emergency medical costs (insurance is indirect billing, so you are strongly recommended to keep some money for emergency cases) : 1,000-5,000 RMB

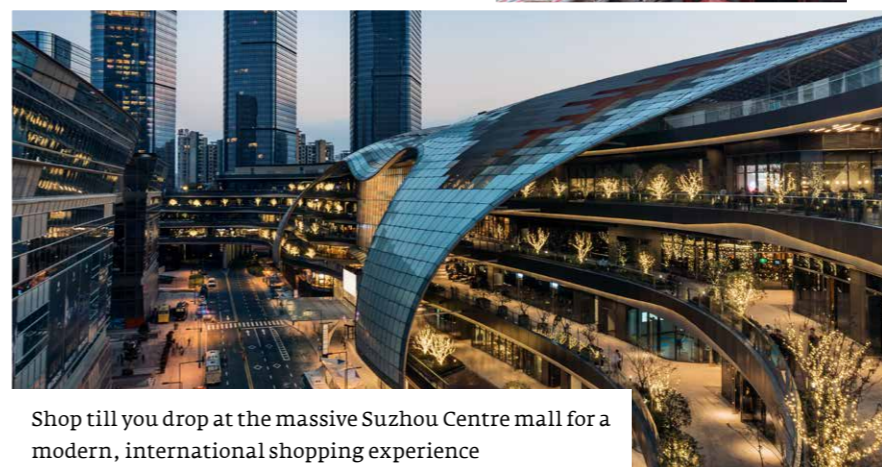

Shop till you drop at the massive Suzhou Centre mall for a modern, international shopping experience

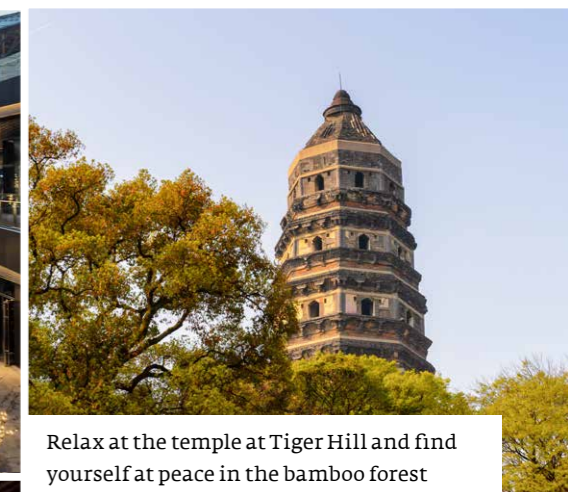

Relax at the temple at Tiger Hill and find yourself at peace in the bamboo forest



Venture to the magical Humble Administrator's Garden – a UNESCO world heritage site



Take a short trip on the weekend and explore Shanghai with your friends

CAREERS OPPORTUNITIES

XJTLU students have numerous job opportunities around the world after they graduate.

Graduates work at institutions and enterprises including the 'Big Four' accounting and consulting firms, foreign-owned banks, financial institutions, foreign-owned manufacturing and developing firms, and large and medium-sized state-owned enterprises.

We are located in Suzhou Industrial Park, which houses more than 5,000 international enterprises and Fortune 500 companies.

Here are some of the global companies where our graduates have received offers of employment.

Microsoft
Google
Apple
Intel
Amazon
Ford
JP Morgan Chase
IBM
Shell
Accenture
Procter & Gamble
L'Oréal

PricewaterhouseCoopers
KPMG
Ernst & Young
Deloitte

HSBC
Standard Chartered Bank
Swiss Bank
Royal Bank of Scotland

Lenovo
Huawei
ZTE
Baidu
Alibaba
SAIC

UNITED KINGDOM

University of Cambridge
University of Oxford
UCL (University College London)
Imperial College London
King's College London
The University of Edinburgh
The University of Manchester
London School of Economics and Political Science (LSE)
The University of Warwick
Durham University

UNITED STATES

Stanford University
Harvard University
Cornell University
Yale University
Johns Hopkins University
Columbia University
University of Pennsylvania
University of California, Berkeley
Northwestern University

AUSTRALIA

Australian National University (ANU)
University of Melbourne
University of New South Wales (UNSW Sydney)
University of Queensland (UQ)
University of Sydney
Monash University

CANADA

University of Toronto
University of British Columbia

FURTHER STUDY

More than 83 percent of our graduates continue onto further studies (Master's degrees and PhD's), with almost 30% entering one of the world top 10 universities and almost 72% percent receiving offers from universities ranking in the world top 100.

GRADUATE STUDY DESTINATIONS

These are some of the top-ranked universities our students have gained entry to after graduating from XJTLU.

HONG KONG, CHINA

The Hong Kong University of Science and Technology

JAPAN

The University of Tokyo
Kyoto University

SINGAPORE

Nanyang Technological University Singapore (NTU)
National University of Singapore (NUS)

REPUBLIC OF KOREA

Seoul National University



"The professors at XJTLU helped me transform from a high school student to an empowered university graduate. They supported me to study for a postgraduate degree at the National University of Singapore and the Technical University of Munich, which are highly ranked global universities. I feel very confident now I have the strength and ability to achieve all the goals in my life."

MADLINE CHRISTABEL, INDONESIA
BSc APPLIED CHEMISTRY



GLOBAL OPPORTUNITIES

We support our students in becoming global citizens through a wide range of study abroad opportunities that help them build the employable skills needed to succeed in the international employment market. Study abroad experience makes our graduates more employable. There are also academic and personal benefits such as increased self-awareness and self-reliance.



TRANSFER TO THE UNIVERSITY OF LIVERPOOL (2+2 STUDY ROUTE)

XJTLU full-time students*, have the opportunity to take the 2+2 study route, which involves pursuing the first two years of your programme at XJTLU in Suzhou and the final two years at the University of Liverpool in the UK.

*Depending on programme and subject to academic achievement.

MASTERS DISCOUNT

Students who choose to study their undergraduate degree at XJTLU can benefit from our links with the University of Liverpool by applying for a masters degree at the University's London or Liverpool campuses at a discounted tuition fee.

SEMESTER OR YEAR ABROAD

You can take advantage of a number of exciting one or two semester study abroad options, also known as exchange programmes, with some of the world's top universities during Year Three of your undergraduate study. Current partners include leading universities in the UK, North America and Europe.

SUMMER ABROAD

XJTLU partners offer non-credit short-term summer courses in a wide range of subjects covering both undergraduate and postgraduate levels. Eligibility and application procedures vary for different courses. Opportunities are currently available at a number of prestigious universities, including UCLA, UC Berkeley, University College London, HEC Montreal, Politecnico di Torino and Utrecht University, to name but a few.



"I love the organisation of the city, and Suzhou Industrial Park where the campus is located is so nicely laid out.

I'm happy with the facilities and labs at XJTLU and the international teachers here are approachable and passionate about their subjects - they have helped me a lot in my studies."

ALI KHAN
BEng ELECTRONIC SCIENCE AND TECHNOLOGY



STUDENT SUPPORT

The XJTLU Global team provides a range of services to help make your experience at XJTLU go as smoothly as possible. XJTLU Global is the first service point for all international and Hong Kong, Macao and Taiwan students at the University.

VISA AND ACCOMMODATION

XJTLU Global will provide support for arranging your visa and accommodation.

AIRPORT MEET-AND-GREET

XJTLU Global organises a pick-up service for all new international students arriving in China at Shanghai Pudong airport. This service is available during three days of welcome week.

INDUCTION

The induction activities aim to familiarise you with the local area and campus. You will have the opportunity to meet current students during this time, as well as at various social events and societies and clubs introductions.

ENGLISH LANGUAGE SUPPORT

The Language Centre provides continuing support courses to help you with any English language and study skills issues you may find during your studies. Continuing support focuses on academic literacies, study skills, and learning techniques, helping you to bridge the gap between English study and academic subject-specific study.

CHINESE CLASSES

The Language Centre also provides free Chinese language classes to all full-time international students delivered by our globally recognised Language Centre.

CAREER SERVICES

The Career Development Office provides students with support in preparing for successful future careers and assists with work placements and job searches. Their services include lectures and seminars, CV and cover letter advice, workshops on interview techniques, business plans, and career planning. The office also arranges external mentoring with industry professionals as well as maintaining a careers library with books and journals on career planning, together with IT resources to help you with your post-graduation job search.

ALUMNI

When you graduate from XJTLU, you will not only join a growing network of XJTLU alumni, but you will also become a member of the global community of more than 100,000 University of Liverpool alumni in over 130 countries.

STUDENT HELPERS

All students are assigned a friendly 'buddy' to help you get familiar with the campus during your first few weeks and months. You also have the option to pair up with a language partner to learn a second language.

ENTREPRENEURSHIP

With guidance from the Career Development Office and XJTLU Innovation Hub, many students take advantage of the XJTLU Student Enterprise Park to develop their own products and start-up companies.

EXTERNAL MENTOR PROGRAMME

We invite experienced professionals from Chinese and International companies to act as external mentors to provide guidance on the skills that are necessary for your future career.



"Life has never been this good. With extremely warm and friendly staff as well as the locals, it's not hard to absolutely love what this university and this city has to offer."

SUHAILA SULEIMAN, KENYA
BEng TELECOMMUNICATIONS
ENGINEERING



"China is amazing! I feel the people are so welcoming and the atmosphere is definitely more relaxed than the UK. As a minority, you instantly develop a fan base, so bring your good side as there will be lots of pictures!"

KRYSTINA MHLANDHLA, UK
SUMMER SCHOOL



XJTLU ENTREPRENEUR COLLEGE, TAICANG

The XJTLU Entrepreneur College, Taicang, is the University's new model for a next-generation educational facility to produce graduates with deep academic knowledge and industry-specific skills and abilities.

The initiative will focus on seamless collaboration between academic staff, students, industry, government, and the wider community, with the aim of fostering the development of a modern, entrepreneurial and sustainable society.



"One of the best decisions I've made in my life is to dive into the pool of opportunities at XJTLU. I've sharpened my skills in risk management, planning, problem solving, creative production and entrepreneurship; and as a result, received employment offers from leading creative agencies in Shanghai."

MEITING SHU YE, HONDURAS
MSc PROJECT MANAGEMENT



Located in the north-east of Suzhou, the six schools housed at the new campus are designed to help graduates become future leaders and prepare for challenges from disruptive technology, rapid innovation, and shifting market demand.

School of Artificial Intelligence and Advanced Computing
BEng Data Science and Big Data Technology

School of Intelligent Manufacturing Ecosystem
BEng Intelligent Manufacturing Engineering

School of Intelligent Finance and Business
BSc Intelligent Supply Chain

School of Robotics
BEng Intelligent Robotics Engineering

School of Internet of Things
BEng Internet of Things Engineering

School of Cultural Technology
BA Arts, Technology and Entertainment



“

“I originally planned to study in the UK, but I thought that studying in China would provide more job opportunities, that it would be good to experience the market in China first-hand and also learn Chinese. XJTLU is a great place and you can get degrees from both Liverpool and XJTLU. There’s a real international atmosphere, making it easy to make friends from different countries. The scholarship opportunity made the decision to join XJTLU an easy one.”

MARIA CHRISTOFORIDOU, UK
BA MARKETING



SCHOLARSHIPS

ENTRY SCHOLARSHIP

XJTLU offers generous entry scholarships of up to 50 percent off the first year tuition fees. This is based on academic merit and is renewable annually based on your continuing strong academic performance.

GOVERNMENT SCHOLARSHIPS

The Chinese Ministry of Education and the Jiangsu provincial government offer scholarships to international students. Additional scholarships are available to Hong Kong, Macao and Taiwan students.

PROGRESSION SCHOLARSHIP*

Progression scholarships are awarded annually on the basis of a student’s overall average marks in the previous academic year.

THE UNIVERSITY OF LIVERPOOL DISCOUNT*

All students enrolling at XJTLU in September, who choose to transfer to the University of Liverpool on the 2+2 study route, will be offered a discount of 10 percent off the tuition fees of the University of Liverpool.

*undergraduate applicants only



“I decided to study at XJTLU as being a joint venture university between Xi’an Jiaotong-University and the University of Liverpool I can get the best of both worlds. It’s a really diverse university both culturally and for the programmes that are offered. The opportunities in China are increasing and I am able to learn about how people think and do business in China.”

NICK SUKHUMANANT, THAILAND
BSC FINANCIAL MATHEMATICS

”



UNDERGRADUATE DEGREE PROGRAMMES

XJTLU has bachelor degree programmes in the areas of engineering, science, architecture and design, mathematics, business, management, language, communication and culture.

Depending on their programme, students may choose to study for four years onsite at XJTLU in Suzhou, or study at XJTLU and then transfer to the University of Liverpool in the UK for the final two years of their degree. Regardless of their study route,

full-time undergraduate students receive **dual degrees** upon successful completion of studies.

The quality of our degree programmes is ensured by means of a rigorous quality assurance system established in line with the requirements of the **British Quality Assurance Agency**, supported by high-calibre academic staff and world-renowned scholars recruited from both China and the rest of the world.

● 2+2 STUDY ROUTE AVAILABLE

ARCHITECTURE

The department engages with the challenges and contradictions of architecture in China in an open-minded and forward-thinking manner. Students are encouraged to seek answers to the questions facing both local and international architecture today.

■ **BEng ARCHITECTURE** ●

BIOLOGICAL SCIENCES

Biology provides insights into life processes, together with advances in genomics, diagnostics and therapeutic drug development, are having a major impact on humanity. The department aims to make fundamental discoveries as well as to address some of the most pressing challenges facing society.

■ **BSc BIOINFORMATICS** ●
■ **BSc BIOLOGICAL SCIENCES** ●

CHEMISTRY

Chemistry is the foundation of many of today's frontier research, from nano-technology to computer chips, and from green energy to molecular biology. The department's research emphasis focusses mainly on chemical biology and advanced functional materials.

■ **BSc APPLIED CHEMISTRY** ●

CHINA STUDIES

The department teaches and researches China's history and culture, society and politics, business and economics. The department also has an active outreach educational programme for staff at XJTLU and in the wider community.

■ **BACHINA STUDIES**



SCAN TO VIEW ALL OF OUR
DEGREE PROGRAMMES
www.xjtlu.edu.cn/en/find-a-programme/?lev=undergraduate

● 2+2 STUDY ROUTE AVAILABLE

CIVIL ENGINEERING	<p>China is currently witnessing rapid economic transformation, alongside unprecedented urbanisation and civil engineering students will be able to take full advantage of China's evolution. Graduates are technical professionals with an international outlook that can meet future industrial development requirements.</p> <ul style="list-style-type: none"> ■ BEng ARCHITECTURAL ENGINEERING ● ■ BEng CIVIL ENGINEERING ●
COMPUTER SCIENCE AND SOFTWARE ENGINEERING	<p>The department equips students with a broad knowledge of computer-based systems. Students learn how to use their skills creatively to solve practical problems, as well as learn how cutting-edge computer technology is developed.</p> <ul style="list-style-type: none"> ■ BEng COMPUTER SCIENCE AND TECHNOLOGY ● ■ BSc INFORMATION AND COMPUTING SCIENCE ●
ELECTRICAL AND ELECTRONIC ENGINEERING	<p>Programmes are designed to give students solid training in information technology, both software and hardware. Emphasis is placed on the principles of electrical and electronic engineering as well as on more specialised subject areas.</p> <ul style="list-style-type: none"> ■ BEng DIGITAL MEDIA TECHNOLOGY ■ BEng ELECTRICAL ENGINEERING ● ■ BEng ELECTRONIC SCIENCE AND TECHNOLOGY ● ■ BEng MECHATRONICS AND ROBOTIC SYSTEMS ● ■ BEng TELECOMMUNICATIONS ENGINEERING ●
ENGLISH	<p>The department prepares graduates for careers as English-language professionals in the fields of translation, media and communication, finance and international business, linguistics and language education.</p> <ul style="list-style-type: none"> ■ BA APPLIED ENGLISH ● ■ BA ENGLISH AND COMMUNICATION STUDIES ● ■ BA ENGLISH AND FINANCE ■ BA ENGLISH AND INTERNATIONAL BUSINESS ●
HEALTH AND ENVIRONMENTAL SCIENCES	<p>The department aims to provide holistic solutions for big environmental issues in China and elsewhere, such as living with environmental change, biodiversity loss, pollution, land and water management.</p> <ul style="list-style-type: none"> ■ BSc ENVIRONMENTAL SCIENCE ●
INTERNATIONAL BUSINESS SCHOOL SUZHOU	<p>IBSS aims to prepare Chinese students for international business and international students for doing business in or with China. The School is based on strong principles of internationalism and innovation and its academic staff has an impressive track record of proven business expertise across the subject fields of management, economics and finance.</p> <ul style="list-style-type: none"> ■ BA ACCOUNTING ● ■ BA BUSINESS ADMINISTRATION ● ■ BSc ECONOMICS ● ■ BSc ECONOMICS AND FINANCE ● ■ BA HUMAN RESOURCE MANAGEMENT ● ■ BSc INFORMATION MANAGEMENT AND INFORMATION SYSTEMS ● ■ BA INTERNATIONAL BUSINESS WITH A LANGUAGE ● ■ BA MARKETING ●

● 2+2 STUDY ROUTE AVAILABLE

INDUSTRIAL DESIGN	<p>The department focusses on user-centred product and systems design for society in response to social, cultural, and technical context. It aims to educate a new generation of industrial and product designers for China's ongoing social, cultural, and economic transformation.</p> <ul style="list-style-type: none"> ■ Beng INDUSTRIAL DESIGN ●
INTERNATIONAL RELATIONS	<p>The Department aims to deepen the knowledge of China's growing interactions with the rest of the world and to produce the entrepreneurial and managerial leaders of the future who will bring China to the world and the world to China.</p> <ul style="list-style-type: none"> ■ BA INTERNATIONAL RELATIONS
MATHEMATICAL SCIENCES	<p>The department's academic staff are internationally recognised for their high-quality research in a number of areas of modern mathematics. The mathematical and computational sciences are among the major research strengths of XJTLU.</p> <ul style="list-style-type: none"> ■ BSc ACTUARIAL SCIENCE ● ■ BSc APPLIED MATHEMATICS ● ■ BSc FINANCIAL MATHEMATICS ●
URBAN PLANNING AND DESIGN	<p>Students studying urban planning and design develop understanding of the processes of spatial change in the built and natural environment and engage the arguments for intervening in these processes. Students develop the knowledge and skills to analyse, critique and ultimately contribute to the sustainability of urban and rural development both in China and around the world.</p> <ul style="list-style-type: none"> ■ BA URBAN PLANNING AND DESIGN ●
SCHOOL OF FILM AND TV ARTS	<p>The School aims to provide students with an understanding of theory-informed practice within cinema, broadcast television, the media in its many changing forms, and broader industries including digital media technology and arts, equipping students with an international vision and the language and communication skills to achieve this.</p> <ul style="list-style-type: none"> ■ BA COMMUNICATION STUDIES ● ■ BA DIGITAL MEDIA ARTS ■ BA FILM AND TELEVISION PRODUCTION ■ BA FILMMAKING
XJTLU ENTREPRENEUR COLLEGE (TAICANG)	<p>The programmes at the new Taicang campus are designed to help graduates become future leaders and prepare for challenges from disruptive technology, rapid innovation, and shifting market demand.</p> <ul style="list-style-type: none"> ■ BA ART, TECHNOLOGY AND ENTERTAINMENT ■ BENG INTERNET OF THINGS ENGINEERING ■ BENG INTELLIGENT MANUFACTURING ENGINEERING ■ BENG DATA SCIENCE AND BIG DATA TECHNOLOGY ■ BENG INTELLIGENT ROBOTICS ENGINEERING ■ BSc INTELLIGENT SUPPLY CHAIN



SCAN TO VIEW ALL OF OUR DEGREE PROGRAMMES
www.xjtlu.edu.cn/en/find-a-programme/?lev=undergraduate

HOW TO APPLY FOR AN UNDERGRADUATE DEGREE

ENTRY INTO YEAR ONE

We welcome applications from high-quality candidates in all subject areas with appropriate high school or equivalent qualifications. Students will normally be expected to have a high standing in their high school performance with a minimum “B” average in relevant subjects.

ENTRY INTO YEAR TWO

On the bases of year one criteria, students who have completed A-levels or International Baccalaureate (or equivalent) will be considered for entry into Year Two, different programmes have different subject-relevant requirements:

- A-level: BBB
- IB Diploma: 30 points
- Advanced Placement Tests/Subject SATS--High school diploma with a GPA of 3.0 or above, plus:
 - Redesigned SAT: 1280+ (students that took the SATs previous to 2016 will require 1800+) or ACT: 27, and 2 AP examinations: 4+ or 2 SAT subject tests: 600+ or
 - 3 AP examinations: 4+ or
 - 3 SAT subjects: 600+

HONG KONG, MACAO AND TAIWAN

Students from Hong Kong, Macao and Taiwan may apply with the following:

- A minimum grade of 400 on the Joint Entrance Examination to Chinese Universities for Overseas Chinese Students and Students from Hong Kong, Macao and Taiwan, or
- General Scholastic Ability Test (GSAT) ranking of at least top 50 percent in 4 subjects, including English and Math.

ENGLISH LANGUAGE REQUIREMENTS

YEAR ONE ENTRY	IELTS 5.0 TOEFL iBT 62
YEAR TWO ENTRY	IELTS 6.5 TOEFL iBT 90

English qualifications are not required for students from Hong Kong, Macao and Taiwan who take the Joint Examination or the GSAT.

TUITION FEES

For international, Hong Kong, Macau and Taiwan students:
88,000 RMB per year (approximately US\$13,000)

THE CLOSING DATE FOR SEPTEMBER 2020 ENTRY IS 15 JUNE 2020

CHECKLIST

- Certificates of education qualifications and transcripts, translated into English
- Certificates of English language qualifications such as IELTS, TOEFL or other acceptable English qualifications (as required for non-native speakers of English)
- SAT, ACT, GSAT or other entrance aptitude test scores (if available)
- Personal Statement
- Photocopy of your passport or ID
- Portfolio (required for BEng Architecture & BA Filmmaking)

EARLY BIRD DISCOUNT

All international and Hong Kong, Macao and Taiwan students who submit an online application and accept their conditional or unconditional offer by 1 May 2020 will automatically qualify for a 8,000 RMB early bird discount.

Hong Kong, Macao and Taiwan students who apply to XJTLU with Joint Entrance Examination through the governmental online application system (The Education Examination Authority of Guangdong Province) will automatically qualify for a 8,000 RMB early bird discount.

Applications will be considered as they are received and we encourage you to submit your application well in advance of the deadline. If you have any questions about the admission process, don't hesitate to contact us at international@xjtlu.edu.cn

APPLY ONLINE

All applicants should apply via our online application system – to begin, simply choose your programme on our website and click the “apply” button. You will then be prompted to create an account, complete the application form, upload the required documents and submit. You may save and re-log in to your application form at any time.

Visit: www.xjtlu.edu.cn

Note: The University reserves the right to modify programmes at any time in response to unforeseen circumstances, feedback and review. The University also reserves the right to not offer programmes with low enrolments. For the latest information, please visit our website.



MASTER'S DEGREE PROGRAMMES

Our master's degrees, awarded by the University of Liverpool, equip you with the skills and knowledge to pursue your career in a relevant field, or conduct pioneering research in an academic or industrial setting.

You can customise your degree with an 'additional learning activity' such as foreign language study, teaching, research,

internship, training or community engagement.

All degrees are taught in English by world-class international academic staff and industry experts, and range from 18 months (full time) to 36 months (part time).

Tuition fees vary by programme and generous scholarships are available.



SCAN TO VIEW ALL OF OUR DEGREE PROGRAMMES
www.xjtlu.edu.cn/en/find-a-programme/?lev=masters

DEPARTMENT	PROGRAMME	DURATION	TUITION FEES	ENTRY REQUIREMENTS
ARCHITECTURE	● MASTER OF ARCHITECTURAL DESIGN	24 months (full-time)	RMB 160,000	An undergraduate degree (UK 2:1 or equivalent) in BArch, BEng in Architecture, BA (Hons) in Architecture or equivalent. Applicants are required to submit a portfolio of their own creative works as a student and a practicing architect/intern (indicating where and when the work was done, who the tutor/supervisor was, who was part of the team and what the applicants' role was in the team, A3-size, typically 10 to 30 pages, in PDF format). An internship in an architecture-related practice is recommended, but not required. We might accept applicants with substantial work experience or an outstanding portfolio even if their grades are lower than the minimum entry requirements.
BIOLOGICAL SCIENCES	■ MRES MOLECULAR BIOSCIENCE	18 months (full-time)	RMB 90,000	An undergraduate degree (UK 2:1 or equivalent) in a life science-related discipline.
CHEMISTRY	■ MRES ADVANCED CHEMICAL SCIENCES	18 months (full-time)	RMB 90,000	An undergraduate degree (UK 2:1 or equivalent) in chemistry or a related discipline.
CHINA STUDIES	◆ MA CHINA STUDIES	18 months (full-time)	RMB 90,000	An undergraduate degree (UK 2:1 or equivalent) in any discipline.
CIVIL ENGINEERING	● MSC CIVIL ENGINEERING	18 months (full-time), 36 months (part-time)	RMB 90,000	An undergraduate degree (UK 2:1 or equivalent) in a relevant field such as civil engineering or a related programme.
	● MSC SUSTAINABLE CONSTRUCTION	18 months (full-time), 36 months (part-time)	RMB 90,000	An undergraduate degree (UK 2:1 or equivalent) in a relevant field such as civil engineering or a related programme.

ENGLISH REQUIREMENTS

- IELTS: 6.0 (minimum of 5.0 in all sections) / TOEFL iBT:80
- IELTS: 6.5 (minimum of 5.5 in all sections) / TOEFL iBT:90, minimum of 21 in any skill
- ▲ IELTS: 7.0 (minimum of 6.0 in all sections) / TOEFL iBT:100, minimum of 21 in any skill
- ◆ IELTS: 7.0 (minimum of 7.0 in all sections) / TOEFL iBT:100, minimum of 21 in any skill

MINIMUM ENTRY REQUIREMENTS

UK: 2:1 or equivalent
 China: Overall weighted average 75-85%, depending on the institution.
 North America: GPA 3.0 out of 4 or 3.2 in the final two years of UG study

DEPARTMENT	PROGRAMME	DURATION	TUITION FEES	ENTRY REQUIREMENTS
COMPUTER SCIENCE AND SOFTWARE ENGINEERING	■ MSC APPLIED INFORMATICS	18 months (full-time)	RMB 90,000	An undergraduate degree (UK 2:1 or equivalent) in information and computing science, information and management systems, or related fields such as engineering or finance.
	● MRES COMPUTER SCIENCE	18 months (full-time)	RMB 90,000	An undergraduate degree (UK 2:1 or equivalent) in a computer science-related discipline with suitable programming and programme design experience.
	■ MSC SOCIAL COMPUTING	18 months (full-time)	RMB 90,000	An undergraduate degree (UK 2:1 or equivalent) in computer science, engineering, information systems, e-business, or mathematics, with suitable programming and programme design experience.
	■ MSC FINANCIAL COMPUTING	18 months (full-time)	RMB 90,000	An undergraduate degree (UK 2:1 or equivalent) in a relevant area such as computer science, finance and investment, information systems, e-business and mathematics, with some programming and program design experience.
ELECTRICAL AND ELECTRONIC ENGINEERING	■ MRES LOW CARBON ELECTRICAL POWER AND ENERGY TECHNOLOGY	18 months (full-time)	RMB 90,000	An undergraduate degree (UK 2:1 or equivalent) in a relevant field, such as: electrical engineering, telecommunication engineering, computer science and technology, mathematics, semiconductor physics, automation and control, embedded systems, thermal physics, and other related majors.
	■ MSC MULTIMEDIA TELECOMMUNICATIONS	18 months (full-time)	RMB 90,000	An undergraduate degree (UK 2:1 or equivalent) in a relevant field such as telecommunication engineering, electronic science and technology, electrical engineering, and computer science and technology.
	■ MSC SUSTAINABLE ENERGY TECHNOLOGY	18 months (full-time)	RMB 90,000	An undergraduate degree (UK 2:1 or equivalent) in a relevant field such as electrical engineering, electronic science and technology, telecommunication engineering, computer science and technology, mathematics, semiconductor physics, automation and control, embedded systems, engineering thermal physics or other related disciplines.

DEPARTMENT	PROGRAMME	DURATION	TUITION FEES	ENTRY REQUIREMENTS
ENGLISH	▲ MA TESOL	18 months (full-time), 30 months (part-time)	RMB 90,000	An undergraduate degree (UK 2:1 or equivalent) in a relevant field such as English, linguistics, or education and literature. No teaching experience is required, but some relevant teaching experience at secondary or tertiary level would be an advantage.
	● MDES INDUSTRIAL DESIGN	18 months (full-time), 30 months (part-time)	RMB 90,000	An undergraduate degree in industrial design, engineering, architecture, urban planning and design, or other design-related discipline.
INTERNATIONAL BUSINESS SCHOOL SUZHOU	● MSC BUSINESS ANALYTICS	18 months (full-time)	RMB 120,000	An undergraduate degree (UK 2:1 or equivalent) in economics, management, finance, marketing, science or engineering. Prior knowledge of econometrics is desirable, but not essential.
	● MSC ECONOMICS AND FINANCE	18 months (full-time)	RMB 120,000	An undergraduate degree (UK 2:1 or equivalent) in finance, accounting, economics, management, science or engineering and some understanding of quantitative methods, statistics or econometrics.
	● MSC FINANCE	18 months (full-time)	RMB 120,000	An undergraduate degree (UK 2:1 or equivalent) in finance, accounting, economics, management, science or engineering and some understanding of quantitative methods, statistics or econometrics.
INTERNATIONAL BUSINESS SCHOOL SUZHOU	● INTERNATIONAL MBA	24 months (part-time)	RMB 260,000	The ideal candidate is a manager with eight years' work experience, some of which should be in a managerial position, and an undergraduate degree (UK 2:1 or equivalent) in any discipline.
	● MSC INVESTMENT MANAGEMENT	18 months (full-time)	RMB 120,000	An undergraduate degree (UK 2:1 or equivalent) in mathematics, finance, or a related subject. Or relevant work experience and a good knowledge of quantitative methods, statistics or financial mathematics.

DEPARTMENT	PROGRAMME	DURATION	TUITION FEES	ENTRY REQUIREMENTS
INTERNATIONAL BUSINESS SCHOOL SUZHOU	● MSC MANAGEMENT	18 months (full-time)	RMB 120,000	Bachelor Degree in business related subjects (perferred).
	● MSC OPERATIONS AND SUPPLY CHAIN MANAGEMENT	18 months (full-time), 36 months (part-time)	RMB 120,000	An undergraduate degree (UK 2:1 or equivalent) in any discipline.
	● MSC PROFESSIONAL ACCOUNTING	18 months (full-time)	RMB 140,000	An undergraduate degree (UK 2:1 or equivalent) in accounting. It is essential to have passed at least four ICAEW Certificate Level (CFAB) papers on entry. Equivalent degrees or papers are also acceptable if qualified as Credit for Prior Learning by ICAEW or ACCA. Students who have not completed CFAB will need to do so prior to seeking full membership of the ICAEW. Applicants who do not have an equivalent UK degree in Accounting will also be considered if they have completed the six ICAEW Certificate Level (CFAB) papers or equivalent. Applicants with a professional background rather than a degree need to demonstrate relevant training record and working experience in an accounting and finance environment. Such applications will be assessed on a case-by-case basis and are subject to approval by XJTLU Academic Affairs.
INTERNATIONAL BUSINESS SCHOOL SUZHOU	● MSC PROJECT MANAGEMENT	18 months (full-time), 30 months (part-time)	RMB 120,000	An undergraduate degree (UK 2:1 or equivalent) in any discipline.
	● MSC FINANCIAL MATHEMATICS	18 months (full-time)	RMB 90,000	An undergraduate degree (UK 2:1 or equivalent) in a relevant field, such as mathematics, statistics, physics, engineering, computer science, finance and economics.

ENGLISH REQUIREMENTS

- IELTS: 6.0 (minimum of 5.0 in all sections) / TOEFL iBT:80
- IELTS: 6.5 (minimum of 5.5 in all sections) / TOEFL iBT:90, minimum of 21 in any skill
- ▲ IELTS: 7.0 (minimum of 6.0 in all sections) / TOEFL iBT:100, minimum of 21 in any skill
- ◆ IELTS: 7.0 (minimum of 7.0 in all sections) / TOEFL iBT:100, minimum of 21 in any skill

MINIMUM ENTRY REQUIREMENTS

UK: 2:1 or equivalent
 China: Overall weighted average 75-85%, depending on the institution.
 North America: GPA 3.0 out of 4 or 3.2 in the final two years of UG study

DEPARTMENT	PROGRAMME	DURATION	TUITION FEES	ENTRY REQUIREMENTS
URBAN PLANNING AND DESIGN	● MSc URBAN PLANNING (SPECIALISATION IN URBAN DESIGN)	18 months (full-time), 30 months (part-time)	RMB 90,000	An undergraduate degree (UK 2:1 or equivalent) in industrial design, engineering, architecture, urban planning and design, or another design-related discipline.
	● MSc URBAN PLANNING	18 months (full-time)	RMB 90,000	An undergraduate degree (UK 2:1 or equivalent) in a relevant field, such as urban planning and design, architecture, geography, economics, management, environmental science, social or public policy.
SCHOOL OF FILM AND TV ARTS	▲ MSc MEDIA AND COMMUNICATION	18 months (full-time), 30 months (part-time)	RMB 90,000	An undergraduate degree (UK 2:1 or equivalent) in communication, media, English with media or similar. No practical experience is required, but some relevant media practice/background would be an advantage.

ENGLISH REQUIREMENTS

- IELTS: 6.0 (minimum of 5.0 in all sections) / TOEFL iBT:80
- IELTS: 6.5 (minimum of 5.5 in all sections) / TOEFL iBT:90, minimum of 21 in any skill
- ▲ IELTS: 7.0 (minimum of 6.0 in all sections) / TOEFL iBT:100, minimum of 21 in any skill
- ◆ IELTS: 7.0 (minimum of 7.0 in all sections) / TOEFL iBT:100, minimum of 21 in any skill

MINIMUM ENTRY REQUIREMENTS

UK: 2:1 or equivalent
 China: Overall weighted average 75-85%, depending on the institution.
 North America: GPA 3.0 out of 4 or 3.2 in the final two years of UG study



"I graduated from a Chinese university previously and the whole experience of being on an international campus has been quite different. We have access to so many resources and a wealth of knowledge from our professors who come from all over the world. Being in China there are so many opportunities in different fields. I'd like to work in event planning as I have some experience with that already and I enjoy it."

KRYSTAL SOROKA, THE BAHAMAS
 MSc MEDIA AND COMMUNICATION



HOW TO APPLY FOR A MASTER'S DEGREE

ENTRY REQUIREMENTS

The minimum entry requirement is a UK upper second class (2:1) or equivalent. However, admission requirements vary depending on the programme you choose.

ENGLISH LANGUAGE REQUIREMENTS

Master's students at XJTLU should have a high level of proficiency in the English language. Non-native speakers will typically require a minimum IELTS score of 6.0 (TOEFL iBT: 80) up to IELTS 7.0 (TOEFL iBT: 100). Students who completed a full-time degree programme delivered wholly in English will normally be exempt from the English language requirements.

If you miss the language requirements by 0.5-1.0 of IELTS then you can still apply for XJTLU by successfully completing a summer Pre-Sessional English (PSE) course at the University.

APPLY ONLINE

All applicants should apply via our online application system. To begin, simply choose your programme on our website and click the "apply" button. You will then be prompted to create an account, complete the application form, upload the required documents and submit. You may save and re-log in to your application form at any time and upload any remaining supporting documents.

Visit: www.xjtlu.edu.cn



THE CLOSING DATE FOR
SEPTEMBER 2020 INTAKE IS
15 JUNE 2020 (INTERNATIONAL)
30 JUNE 2020 (MAINLAND CHINA)

CHECKLIST

- Certificates of education qualifications and transcripts
- Certificates of English language qualification (If applicable)
- Personal Statement
- Two letters of reference
- Scholarship application letter (Optional)
- Photocopy of your passport or ID

TUITION FEES

Tuition fees vary by programme and range from 90,000 RMB to 260,000 RMB. You must secure your place at XJTLU by paying a nonrefundable deposit of 10,000 RMB, which is deducted from the total tuition fee.

Payments can be paid in installments every semester. Students who choose to pay in full upfront at the time of registration, will be entitled to a discount of 5% of the total tuition fee.

ALUMNI DISCOUNT

Graduates of XJTLU, the University of Liverpool or Xi'an Jiaotong University will automatically receive a tuition fee discount of 20 percent.

Applications will be considered as they are received and we encourage you to submit your application well in advance of the deadline. Please refer to the relevant programme page on our website for details.

Note: The University reserves the right to modify programmes at any time in response to unforeseen circumstances, feedback and review. The University also reserves the right to not offer programmes with low enrolments. For the latest information, please visit our website.

FOLLOW US ON SOCIAL MEDIA

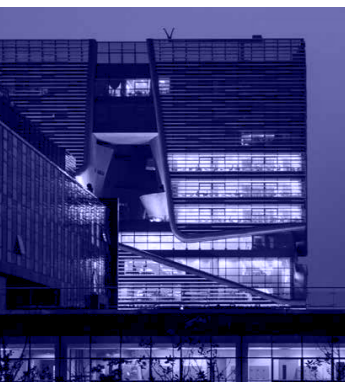

WECHAT ID:
XJTU-CHINA

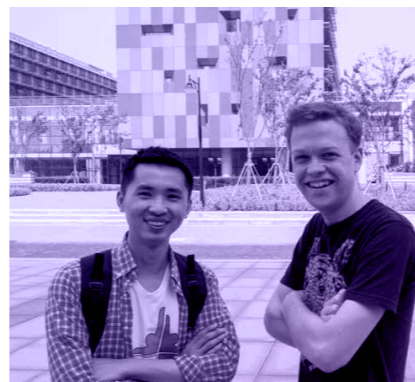

INSTAGRAM.COM/XJTU



FACEBOOK.COM/XJTU



WEIBO.COM/XJTU



LINKEDIN.COM/
SCHOOL/436551

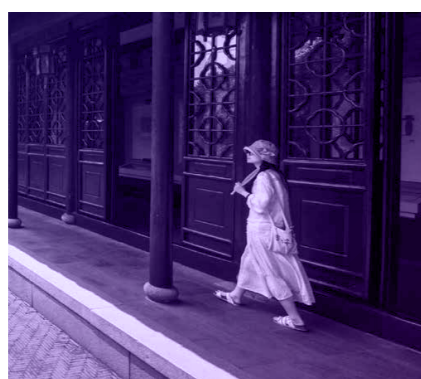

TWITTER.COM/XJTU

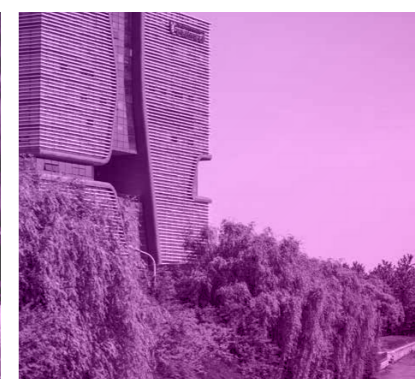



SUZHOU MAP

- SHOPPING & RESTAURANTS
- STUDENT ACCOMMODATION

www.xjtlu.edu.cn

international@xjtlu.edu.cn

+86 (0)512 8816 1889